

### Before Beginning

1. Remove any plastic plugs and ties that would interfere with curb box operation or access to curb valve.
2. Ensure lid and base joints are hand tight.

### Adjustment

1. Loosen nut at top of lower section by turning nut counter-clockwise.
2. Pull up upper section to desired height.  
 \*Note: If equipped, shutoff rod will automatically adjust and remain 12" below lid.
3. Tighten nut hand tight.

### Connecting and Backfill

1. If equipped, connect shutoff rod to valve cap with cotter pin.
2. Connect curb box to valve  
 - Minneapolis Pattern base – Thread Curb box onto valve.  
 - Arch Base – Place arch over valve.
3. Backfill **EVENLY** around curb box.

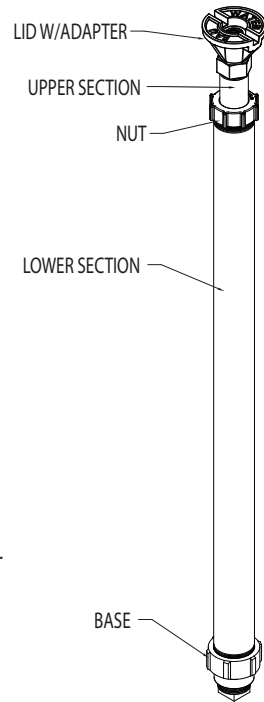

### Telescoping Curb Box Options

#### Lids

##### 5544

1 1/4" Adapter  
 Pentagon Plug  
 with Rope Thread



#### Bases

##### Minneapolis Pattern

2" - 5514CPLG 2 x 2  
 1 1/2" - 5514CPLG 1 1/2 x 2

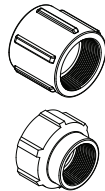

##### Arch Pattern

5504SA



**WARNING:** It is unlawful in **CALIFORNIA & VERMONT** (effective 1/1/2010); **MARYLAND** (effective 1/1/2012); **LOUISIANA** (effective 1/1/2013) and the **UNITED STATES OF AMERICA** (effective 1/4/2014) to use any product in the installation or repair of any public water system or any plumbing in a facility or system that provides water for human consumption if the wetted surface area of the product has a weighted average lead content greater than 0.25%. This prohibition does not extend to service saddles used in California, Louisiana or under USA Public Law 111-380. **▲WARNING:** This product can expose you to chemicals including lead, which is known to the State of **CALIFORNIA** to cause cancer and birth defects or other reproductive harm. For more information go to: [www.P65Warnings.ca.gov](http://www.P65Warnings.ca.gov).

### Before Beginning

1. Remove any plastic plugs and ties that would interfere with curb box operation or access to curb valve.
2. Ensure lid and base joints are hand tight.

### Adjustment

1. Loosen nut at top of lower section by turning nut counter-clockwise.
2. Pull up upper section to desired height.  
 \*Note: If equipped, shutoff rod will automatically adjust and remain 12" below lid.
3. Tighten nut hand tight.

### Connecting and Backfill

1. If equipped, connect shutoff rod to valve cap with cotter pin.
2. Connect curb box to valve  
 - Minneapolis Pattern base – Thread Curb box onto valve.  
 - Arch Base – Place arch over valve.
3. Backfill **EVENLY** around curb box.

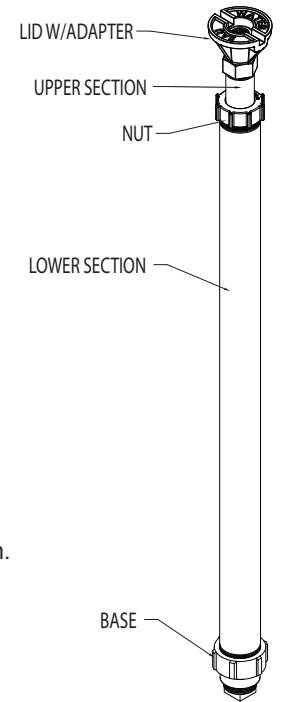

### Telescoping Curb Box Options

#### Lids

##### 5544

1 1/4" Adapter  
 Pentagon Plug  
 with Rope Thread



#### Bases

##### Minneapolis Pattern

2" - 5514CPLG 2 x 2  
 1 1/2" - 5514CPLG 1 1/2 x 2

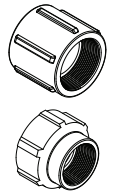

##### Arch Pattern

5504SA



**WARNING:** It is unlawful in **CALIFORNIA & VERMONT** (effective 1/1/2010); **MARYLAND** (effective 1/1/2012); **LOUISIANA** (effective 1/1/2013) and the **UNITED STATES OF AMERICA** (effective 1/4/2014) to use any product in the installation or repair of any public water system or any plumbing in a facility or system that provides water for human consumption if the wetted surface area of the product has a weighted average lead content greater than 0.25%. This prohibition does not extend to service saddles used in California, Louisiana or under USA Public Law 111-380. **▲WARNING:** This product can expose you to chemicals including lead, which is known to the State of **CALIFORNIA** to cause cancer and birth defects or other reproductive harm. For more information go to: [www.P65Warnings.ca.gov](http://www.P65Warnings.ca.gov).